

**HANDE**  
Beneteau Oceanis 45  
2018

Tekne Adı / Boat Name / Name des Boots  
Model / Fabrikat  
Yıl / Year / Jahr

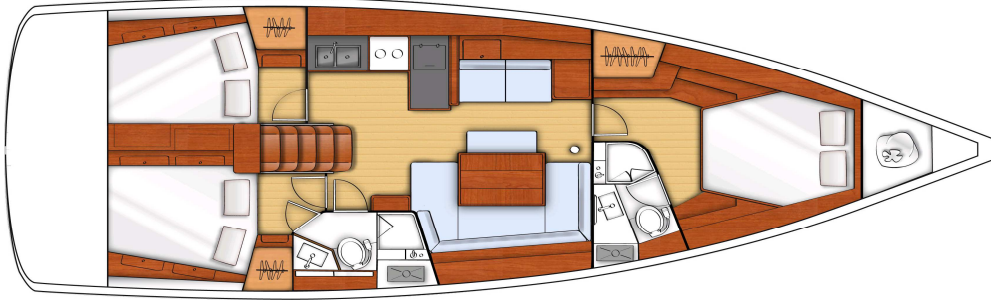

#### **Teknik Özellikler:**

Tam Boy	13.85 m
En	4.49 m
Su Çekimi	2.15 m
Ağırlık (boş)	9.55 ton
Su	570 lt
Mazot	200 lt
Yelken Alanı	100 m <sup>2</sup>
Sarma Ana Yelken	
Sarma Cenova	
Asimetrik balon yelken kullanılabilir (ekstra)	
Motor	Yanmar 57 hp
Kamara	3 + Salon
Yatak	6 + 2
WC / Banyo	2

Uzaktan kumandalı açılır yüzme platformu

2 Dümen simidi

Katlanır pervane

Baş manevra pervanesi

1 x Elektrikli vinç

Tik havuzluk

2 x Elektrikli marin tuvalet

Kalorifer, mazotlu

300 W Inverter (12V DC - 220V AC)

3 x Elektrikli buzdolabı

Fusion Radio, USB, Bluetooth

B&G Zeus T12 haritalı GPS, dümende

2 x B&G Zeus T7 gösterge

(Hız, Derinlik, Rüzgar)

B&G Zeus T7 otopilot + uzaktan kumanda

B&G V50 + H50 VHF Telsiz + AIS

Ultra çapa, 27 kg

Ultra fırdöndü, bosa kancası

100 m x 10 mm zincir

Quick 1000 W ırgat

Zincir sayacı (dümende)

2.40 m. yumuşak tabanlı şişme bot

Aquamot Trend 1.1 (≈ 3.5 hp),

elektrikli motor

Bimini güneşlik

Serpinti köprüğü

Havuzluk minderleri

Yüzme platformu ve duş

Pasarella

Can Salı (8 kişilik)

8 x Otomatik şişme can yeleği

1 x Çocuk can yeleği

Barometre, Termometre

Kılavuz kitaplar

Elektronik ve kağıt haritalar

220 V şarj sistemi

Sıcak su

#### **Technical Data:**

Overall Length	13.85 m
Beam	4.49 m
Draft	2.15 m
Displacement	9.55 tons
Water	570 lt
Fuel	200 lt
Sail Area	100 m <sup>2</sup>
Furling mainsail	
Furling genoa	
Gennaker available (optional extra)	
Engine	Yanmar 57 hp
Cabins	3 + Saloon
Berths	6 + 2
Heads / Showers	2

Remote controlled opening swimming platform

2 Steering wheels

Folding propeller

Bow thruster

1 x Electric winch

Teak cockpit

2 x Electric marine toilets

Warm air heating, diesel

300 W Inverter (12V DC - 220V AC)

3 x Electric fridges

Fusion Radio, USB, Bluetooth

B&G Zeus T12 chartplotter, at the cockpit

2 x B&G Zeus T7 displays

(Speed, Depth, Wind)

B&G Zeus T7 autopilot interface + remote

B&G V50 + H50 VHF Radio + AIS

Ultra anchor, 27 kg

Ultra flip swivel, chain grab

100 m x 10 mm chain

Quick 1000 W windlass

Chain counter (at the cockpit)

2.40 m. soft bottom dinghy

Aquamot Trend 1.1 (≈ 3.5 hp),

electric outboard

Biminitop

Sprayhood

Cockpit cushions

Swimming platform with shower

Gangway

Life raft (8 person)

8 x Automatic inflatable life jackets

1 x Child life jacket

Barometer, Thermometer

Pilot books

Electronic and paper charts

220 V recharging system

Hot water

#### **Technische Daten:**

Länge über alles	13.85 m
Breite	4.49 m
Tiefgang	2.15 m
Verdrängung	9.55 tonnen
Wassertank	570 L
Dieseltank	200 L
Segelfläche	100 m <sup>2</sup>
Grosssegel-Rollrefanlage	
Genua-Rollrefanlage	
Gennaker verfügbar (Optionale Extra)	
Motor	Yanmar 57 PS
Kabinen	3 + Saloon
Kojen	6 + 2
WC und Dusche	2

Badeplattform mit Fernbedienung zum Öffnen

2 Steuerrad

Faltbare Propeller

Bugstrahlruder

1 x elektrische Seilwischen

Teak cockpit

2 x Elektrische Marine-WC

Warmluftheizung, diesel

300 W Wechselrichter

3 x elektr. Kuehlaggregat

Fusion Radio, USB, Bluetooth

B&G Zeus T12 Kartenplotter, im Cockpit

2 x B&G Zeus T7 Anzeige

(Geschwindigkeit, Tiefe, Wind)

B&G Zeus T7 Autopilot Interface + Fernbedienung

B&G V50 + H50 VHF Radio + AIS

Ultra-Anker, 27 kg

Ultra-Schwenker, Kettenhaken

100 m x 10 mm Kette

Quick 1000 W Ankerwinde

Kettenzähler (im cockpit)

2.40 m. weichen Boden Beiboot

Aquamot Trend 1.1 (≈ 3.5 hp),

elektrische-Außenborder

Biminitop

Sprayhood

Cockpitkissen

Badeplattform mit Dusche

Gangway

Rettungsinsel (8 Person)

8 x Auto. aufblasbare Schwimmweste

1 x Kinder-Schwimmweste

Barometer, Thermometer

Pilot Bücher

Elektronische und Papierkarten

Batterieladegeraet

Warmwasser