

BUSE
Dufour Grand'Large 412
2017

Tekne Adı / Boat Name / Name des Boots
Model / Fabrikat
Yıl / Year / Jahr

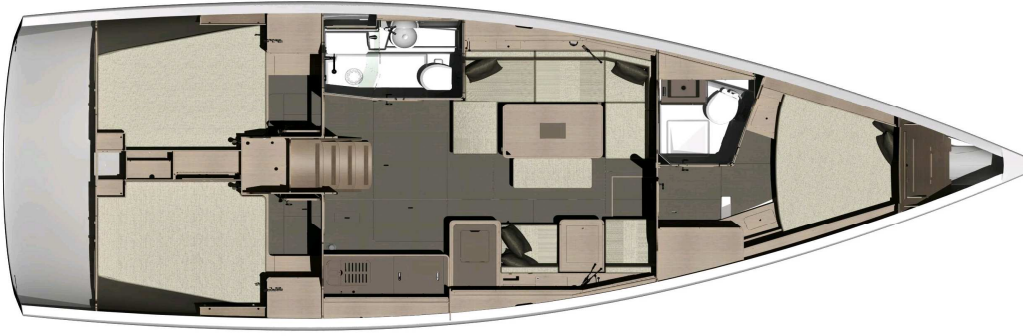

Teknik Özellikler:

Tam Boy	12.35 m
En	4.20 m
Su Çekimi	2.10 m
Ağırlık (boş)	8.94 ton
Su	380 lt
Mazot	200 lt
Yelken Alanı	71 m ²
Sarma Ana Yelken	
Sarma Cenova	
Asimetrik balon yelken kullanılabilir (ekstra)	
Motor	Volvo 60 hp
Kamara	3 + Salon
Yatak	6 + 2
WC / Banyo	2

2 Dümen simidi (fiberglas)

1 x Elektrikli vinç

Yatağa dönüştürülebilir havuzluk oturakları

Tik havuzluk

2 x Elektrikli marin tuvalet

Kalorifer, mazotlu

300 W Inverter (12V DC - 220V AC)

1 x Elektrikli buzdolabı, 1 x dondurucu

220 V mikrodalg fırın

Radyo, CD, USB, AUX girişi

Raymarine es75 haritalı GPS, dümende

2 x Raymarine i70 gösterge

(Hız, Derinlik, Rüzgar)

Raymarine p70 otopilot arayüzü

Raymarine Ray50 VHF Telsiz

Ultra çapa, 21 kg

Ultra fırdöndü, bosa kancası

100 m x 10 mm zincir

Quick 1000 W ırgat

Zincir sayacı (dümende)

2.40 m. yumuşak tabanlı şişme bot

Aquamot Trend 1.1 (≈ 3.5 hp),

elektrikli motor

Bimini güneşlik

Serpinti körüğü

Havuzluk minderleri

Yüzme platformu ve duş

Pasarella

Can Salı (8 kişilik)

8 x Otomatik şişme can yeleği

1 x Çocuk can yeleği

Barometre, Termometre

Kılavuz kitaplar

Elektronik ve kağıt haritalar

220 V şarj sistemi

Sıcak su

Technical Data:

Overall Length	12.35 m
Beam	4.20 m
Draft	2.10 m
Displacement	8.94 tons
Water	380 lt
Fuel	200 lt
Sail Area	71 m ²
Furling mainsail	
Furling genoa	
Gennaker available (optional extra)	
Engine	Volvo 60 hp
Cabins	3 + Saloon
Berths	6 + 2
Heads / Showers	2

2 Steering wheels (fiberglass)

1 x Electric winch

Convertible cockpit settees

Teak cockpit

2 x Elektrikli marine toilets

Warm air heating, diesel

300 W Inverter (12V DC - 220V AC)

1 x Elektrikli fridge, 1 x Freezer

220 V microwave oven

Radyo, CD, USB, AUX input

Raymarine es75 chartplotter, at the cockpit

2 x Raymarine i70 display

(Speed, Depth, Wind)

Raymarine p70 autopilot interface

Raymarine Ray50 VHF Radio

Ultra anchor, 21 kg

Ultra flip swivel, chain grab

100 m x 10 mm chain

Quick 1000 W windlass

Chain counter (at the cockpit)

2.40 m. soft bottom dinghy

Aquamot Trend 1.1 (≈ 3.5 hp),

electric outboard

Biminitop

Sprayhood

Cockpit cushions

Swimming platform with shower

Gangway

Life raft (8 person)

8 x Automatic inflatable life jackets

1 x Child life jacket

Barometer, Thermometer

Pilot books

Electronic and paper charts

220 V recharging system

Hot water

Technische Daten:

Länge über alles	12.35 m
Breite	4.20 m
Tiefgang	2.10 m
Verdrängung	8.94 tonnen
Wassertank	380 L
Dieseltank	200 L
Segelfläche	71 m ²
Grosssegel-Rollreffanlage	
Genua-Rollreffanlage	
Gennaker verfügbar (Optionale Extra)	
Motor	Volvo 60 PS
Kabinen	3 + Saloon
Kojen	6 + 2
WC und Dusche	2

2 Steuerrad (fiberglas)

1 x elektrische Seilwischen

In Liegeflächen verwandelbare Sitzgruppe im Heckbereich

Teak cockpit

2 x Elektrische Marine-WC

Warmluftheizung, diesel

300 W Wechselrichter

1 x elektr. Kuehlaggregat, 1 x Gefrierschrank

220 V Mikrowelle Backofen

Radyo, CD, USB, AUX-Eingang

Raymarine es75 Kartenplotter, im Cockpit

2 x Raymarine i70 Anzeige

(Geschwindigkeit, Tiefe, Wind)

Raymarine p70 Autopilot Interface

Raymarine Ray50 VHF Radio

Ultra-Anker, 21 kg

Ultra-Schwenker, Kettenhaken

100 m x 10 mm Kette

Quick 1000 W Ankerwinde

Kettenzähler (im cockpit)

2.40 m. weichen Boden Beiboot

Aquamot Trend 1.1 (≈ 3.5 hp),

elektrische-Außenborder

Biminitop

Sprayhood

Cockpitkissen

Badeplattform mit Dusche

Gangway

Rettungsinsel (8 Person)

8 x Auto. aufblasbare Schwimmweste

1 x Kinder-Schwimmweste

Barometer, Thermometer

Pilot Bücher

Elektronische und Papierkarten

Batterieladegerät

Warmwasser