

LE ANDRA

Bali 4.5

2019

Tekne Adı / Boat Name / Name des Boots

Model / Fabrikat

Yıl / Year / Jahr

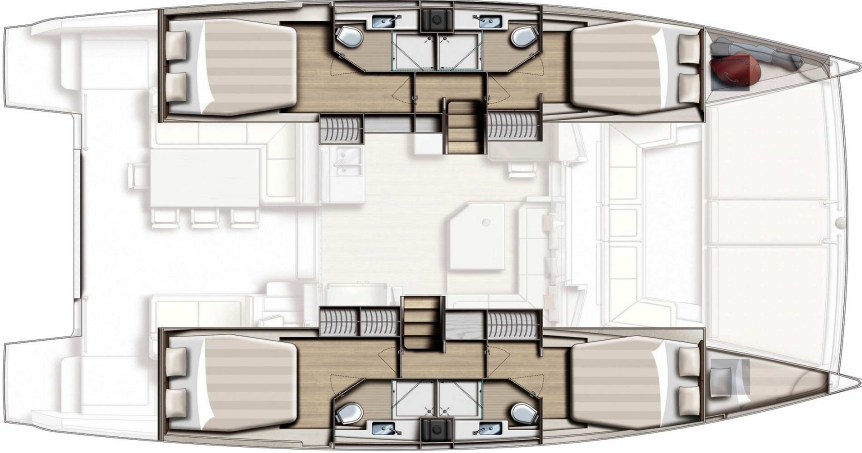
**Teknik Özellikler:**

Tam Boy	13.60 m
En	7.42 m
Su Çekimi	1.22 m
Ağırlık (boş)	11.8 ton
Su, Mazot	800 lt, 800 lt
Yelken Alanı	111 m ²
Klasik Ana Yelken, tam balen	
Sarma Flok (Kendinden Tramolalı)	
Asimetrik balon yelken kullanılabilir (ekstra)	
Motor	2 x Yanmar 57 hp
Kamara	4 + 1 + Havuzluk
Yatak	8 + 2 + 1
WC / Banyo	4

1 Dümen simidi

2 x Katlanır pervane

1 x Elektrikli vinç

4 x Elektrikli marin tuvalet, tatlı su yıkamalı

2 x 125 A alternatör

2000 W Inverter (12V DC - 220V AC)

Elektrikli buzdolabı (615 L) + buz yapıcı

220 V mikrodalga fırın

220 V Bulaşık makinesi

7 x Fan (4+1 kamara, 2 salon)

Radyo, CD, USB, AUX girişi

Raymarine Axiom 12 haritalı GPS, dümende

1 x Raymarine i70s gösterge

(Hız, Derinlik, Rüzgar)

Raymarine p70s otopilot arayüzü

Raymarine Ray60 VHF Telsiz

AIS

Ultra çapa, 27 kg

Ultra fırdöndü, bosa kancası

70 m x 10 mm zincir

Quick 1500 W ırgat

3.30 m. sert tabanlı şişme bot

Mercury 10hp, 4 zamanlı motor

Havuzluk üzeri sabit güneşlik

Serpinti körüğü Havuzluk minderleri

2 x Baş taraf havuzluk masası

Baş taraf havuzluk minderleri ve gölgelik

Yüzme platformu ve duş

Pasarella (2.60 m, PVC)

Can Salı (12 kişilik)

11 x Otomatik şişme can yeleği

1 x Çocuk can yeleği

Barometre, Termometre, Kılavuz Kitaplar

Elektronik ve kağıt haritalar

220 V şarj sistemi

Sıcak su

Technical Data:

Overall Length	13.60 m
Beam	7.42 m
Draft	1.22 m
Displacement	11.8 tons
Water, Fuel	800 lt, 800 lt
Sail Area	111 m ²
Fully battened mainsail with lazy bag	
Furling jib (Self Tacking)	
Gennaker available (optional extra)	
Engine	2 x Yanmar 57 hp
Cabins	4 + 1 + Cockpit
Berths	8 + 2 + 1
Heads / Showers	4

1 Steering wheel

2 x Folding propellers

1 x Electric winch

4 x Electric marine toilets, with fresh water

2 x 125 A alternators

2000 W Inverter (12V DC - 220V AC)

Electric fridge (615 L) + ice maker

220 V microwave oven

220 V Dishwasher

7 x Fans (4+1 cabins, 2 saloon)

Radio, CD, USB, AUX input

Raymarine Axiom 12 chartplotter, at the cockpit

1 x Raymarine i70s display

(Speed, Depth, Wind)

Raymarine p70s autopilot interface

Raymarine Ray60 VHF Radio

AIS

Ultra anchor, 27 kg

Ultra flip swivel, chain grab

70 m x 10 mm chain

Quick 1500 W windlass

3.30 m. rigid bottom dinghy

Mercury 10hp, 4 stroke outboard

Hardtop over the cockpit

Sprayhood Cockpit cushions

2 x Forward cockpit tables

Forward cockpit cushions, sun awning

Swimming platform with shower

Gangway (2.60 m, PVC)

Life raft (12 person)

11 x Automatic inflatable life jackets

1 x Child life jacket

Barometer, Thermometer, Pilot books

Electronic and paper charts

220 V recharging sy:

Hot water

Technische Daten:

Länge über alles	13.60 m
Breite	7.42 m
Tiefgang	1.22 m
Verdrängung	11.8 tonnen
Wassertank, Dieseltank	800 L, 800 L
Segelfläche	111 m ²
Latten-Grosssegel m. Lazy Bag	
Rollflock (selbstwendend)	
Gennaker verfügbar (Optionale Extra)	
Motor	2 x Yanmar 57 PS
Kabinen	4 + 1 + Cockpit
Kojen	8 + 2 + 1
WC und Dusche	4

1 Steuerrad

2 x Faltbare Propeller

1 x elektrische Seilwischen

4 x Elektrische Marine-WC, mit frischem Wasser

2 x 125 A Lichtmaschinen

2000 W Wechselrichter

elektr. Kuehlaggregate (615L) + Eismaschine

220 V Mikrowelle Backofen

220 V Geschirrspüler

7 x Fans (4+1 cabinen, 2 Saloon)

Radio, CD, USB, AUX-Eingang

Raymarine Axiom 12 Kartenplotter, im Cockpit

1 x Raymarine i70s Anzeige

(Geschwindigkeit, Tiefe, Wind)

Raymarine p70s Autopilot Interface

Raymarine Ray60 VHF Radio

AIS

Ultra-Anker, 27 kg

Ultra-Schwenker, Kettenhaken

70 m x 10 mm Kette

Quick 1500 W Ankerwinde

3.30 m. starren Boden Beiboot

Mercury 10PS, 4-Takt-Außenbord

Hardtop über dem Cockpit

Sprayhood Cockpitkissen

2 x Vorwärtscockpittische

Vorwärts Cockpitkissen, Sonnenmarkise

Badeplattform mit Dusche

Gangway (2.60 m, PVC)

Rettungsinsel (12 Person)

11 x Auto. aufblasbare Schwimmweste

1 x Kinder-Schwimmweste

Barometer, Thermometer, Pilot Bücher

Elektronische und Papierkarten

Batterieladegerat

Warmwasser