

MIMPI
Beneteau Oceanis 45
2013

Tekne Adı / Boat Name / Name des Boots
Model / Fabrikat
Yıl / Year / Jahr

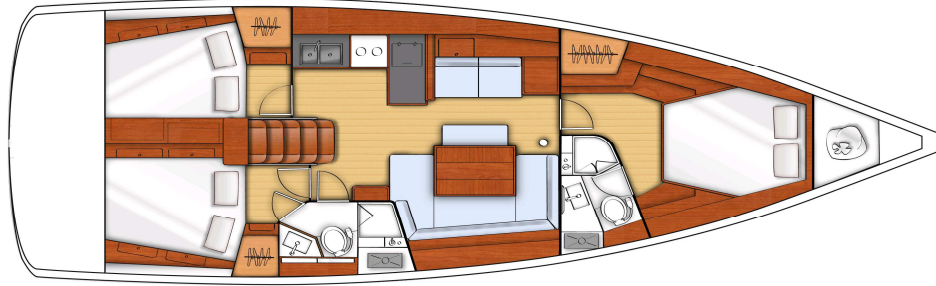

Teknik Özellikler:

Tam Boy	13.85 m
En	4.49 m
Su Çekimi	2.15 m
Ağırlık (boş)	9.55 ton
Su	570 lt
Mazot	200 lt
Yelken Alanı	100 m ²
Sarma Ana Yelken	
Sarma Cenova	
Motor	Yanmar 54 hp
Kamara	3 + Salon
Yatak	6 + 2
WC / Banyo	2

Technical Data:

Overall Length	13.85 m
Beam	4.49 m
Draft	2.15 m
Displacement	9.55 tons
Water	570 lt
Fuel	200 lt
Sail Area	100 m ²
Furling mainsail	
Furling genoa	
Engine	Yanmar 54 hp
Cabins	3 + Saloon
Berths	6 + 2
Heads / Showers	2

Technische Daten:

Länge über alles	13.85 m
Breite	4.49 m
Tiefgang	2.15 m
Verdrängung	9.55 tonnen
Wassertank	570 L
Dieseltank	200 L
Segelfläche	100 m ²
Grossegel-Rollreffanlage	
Genua-Rollreffanlage	
Motor	Yanmar 54 PS
Kabinen	3 + Saloon
Kojen	6 + 2
WC und Dusche	2

Koyu mavi gövde rengi
2 Dümen simidi
Katlanır pervane
Baş manevra pervanesi
1 x Elektrikli vinç
Tik havuzluk ve güverte
2 x Elektrikli marin tuvalet
150 W Inverter (12V DC - 220V AC)
2 x Elektrikli buzdolabı
220 V mikrodalgı fırın
Fusion iPod+USB
Simrad NSS12 haritalı GPS, dümende
2 x Simrad NSS7 gösterge
(Hız, Derinlik, Rüzgar)
Simrad NSS7 otopilot arayüzü
Simrad RS10 VHF Telsiz
AIS: Simrad AIS 300
Ultra çapa, 27 kg
Ultra fırdöndü, bosa kancası
70 m x 10 mm zincir
Quick 1000 W ırgat
Zincir sayacı (dümende)
2.40 m. yumuşak tabanlı şişme bot
Mercury 3.5hp, 4 zamanlı motor

Dark blue hull colour
2 Steering wheels
Folding propeller
Bow thruster
1 x Electric winch
Teak cockpit & deck
2 x Electrical marine toilet
150 W Inverter (12V DC - 220V AC)
2 x Electric fridges
220 V microwave oven
Fusion iPod+USB
Simrad NSS12 chartplotter, at the cockpit
2 x Simrad NSS7 displays
(Speed, Depth, Wind)
Simrad NSS7 autopilot interface
Simrad RS10 VHF Radio
AIS: Simrad AIS 300
Ultra anchor, 27 kg
Ultra flip swivel, chain grab
70 m x 10 mm chain
Quick 1000 W windlass
Chain counter (at the cockpit)
2.40 m. soft bottom dinghy
Mercury 3.5hp, 4 stroke outboard

Dunkelblaue Rumpffarbe
2 Steuerrad
Faltbare Propeller
Bugstrahlruder
1 x elektrische Seilwischen
Teak Cockpit und Deck
2 x Elektrische Marine-WC
150 W Wechselrichter
2 x elektr. Kuehlaggregat
220 V Mikrowelle Backofen
Fusion iPod+USB
Simrad NSS12 Kartenplotter, im Cockpit
2 x Simrad NSS7 Anzeige
(Geschwindigkeit, Tiefe, Wind)
Simrad NSS7 Autopilot Interface
Simrad RS10 VHF Radio
AIS: Simrad AIS 300
Ultra-Anker, 27 kg
Ultra-Schwenker, Kettenhaken
70 m x 10 mm Kette
Quick 1000 W Ankerwinde
Kettenszähler (im cockpit)
2.40 m. weichen Boden Beiboot
Mercury 3.5PS, 4-Takt-Außenbord

Bimini güneşlik
Serpinti körüğü
Havuzluk minderleri
Yüzme platformu ve duş
Pasarella
Can Salı (8 kişilik)
8 x Otomatik şişme can yeleği
1 x Çocuk can yeleği
Barometre, Termometre
Kılavuz kitaplar
Elektronik ve kağıt haritalar
220 V şarj sistemi
Sıcak su

Biminitop
Sprayhood
Cockpit cushions
Swimming platform with shower
Gangway
Life raft (8 person)
8 x Automatic inflatable life jackets
1 x Child life jacket
Barometer, Thermometer
Pilot books
Electronic and paper charts
220 V recharging system
Hot water

Biminitop
Sprayhood
Cockpitkissen
Badeplattform mit Dusche
Gangway
Rettungsinsel (8 Person)
8 x Auto. aufblasbare Schwimmweste
1 x Kinder-Schwimmweste
Barometer, Thermometer
Pilot Bücher
Elektronische und Papierkarten
Batterieladegeraet
Warmwasser

Opsiyonel Ekstra

Klima, tüm kamaralar ve salonda

*Sahil elektriğine bağlıyken soğutma ve ısıtma

Available as an Optional Extra

Air conditioning in all cabins & saloon

*Cooling or heating when connected to shore power

Extra-Optionen

Klimaanlage in allen Kabinen & Salon

*Kühlung bzw.Heizung beim elektrischen Landanschluss