

**KOPERNİK**  
Dufour Grand'Large 335  
2013

Tekne Adı / Boat Name / Name des Boots  
Model / Fabrikat  
Yıl / Year / Jahr

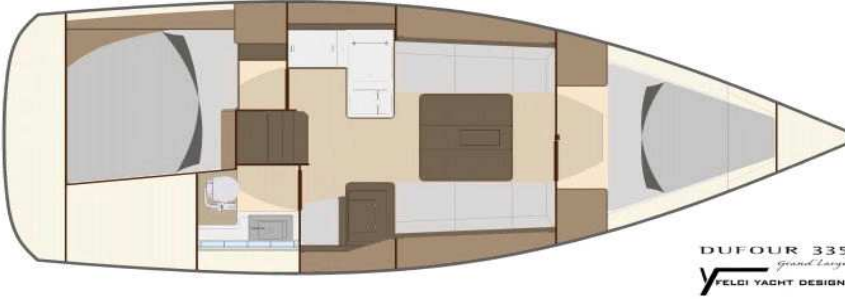

DUFOUR 335  
Grand'Large  
VELDT YACHT DESIGN

#### **Teknik Özellikler:**

Tam Boy 10.28 m  
En 3.49 m  
Su Çekimi 1.90 m  
Ağırlık (boş) 5.45 ton  
Su 380 lt  
Mazot 160 lt  
Yelken Alanı 56 m<sup>2</sup>  
Klasik Ana Yelken, tam balen  
Sarma Cenova  
Asimetrik balon yelken kullanılabilir (ekstra)  
Motor Volvo 29 hp  
Kamara 2 + Salon  
Yatak 4 + 2  
WC / Banyo 1

2 Dümen simidi

Katlanır pervane

Tik havuzluk

Kalorifer, mazotlu

300 W Inverter (12V DC - 220V AC)

Elektrikli buzdolabı

Radyo, CD, USB, AUX girişi

Garmin GpsMap 5008 haritalı GPS, dümende

1 x Garmin GMI 10 gösterge

2 x Garmin GMI 20 gösterge

(Hız, Derinlik, Rüzgar)

Garmin GHC10 otopilot arayüzü

Garmin VHF 200i VHF Telsiz

Ultra çapa, 16 kg

Ultra firdöndü, bosa kancası

60 m x 10 mm zincir

Quick 700 W ırgat

2.20 m. yumuşak tabanlı şişme bot

Mercury 3.5hp, 4 zamanlı motor

Bimini güneşlik

Serpinti körüğü

Havuzluk minderleri

Yüzme platformu ve duş

Pasarella

Can Salı (6 kişilik)

6 x Otomatik şişme can yeleği

1 x Çocuk can yeleği

Barometre, Termometre

Kılavuz kitaplar

Elektronik ve kağıt haritalar

220 V şarj sistemi

Sıcak su

#### **Technical Data:**

Overall Length 10.28 m  
Beam 3.49 m  
Draft 1.90 m  
Displacement 5.45 tons  
Water 380 lt  
Fuel 160 lt  
Sail Area 56 m<sup>2</sup>  
Fully battened mainsail with lazy bag  
Furling genoa  
Gennaker available (optional extra)  
Engine Volvo 29 hp  
Cabins 2 + Saloon  
Berths 4 + 2  
Heads / Showers 1

2 Steering wheels

Folding propeller

Teak cockpit

Warm air heating, diesel

300 W Inverter (12V DC - 220V AC)

Electric fridge

Radio, CD, USB, AUX input

Garmin GpsMap 5008 chartplotter, at the cockpit

1 x Garmin GMI 10 display

1 x Garmin GMI 20 display

(Speed, Depth, Wind)

Garmin GHC10 autopilot interface

Garmin VHF 200i VHF Radio

Ultra anchor, 16 kg

Ultra flip swivel, chain grab

60 m x 10 mm chain

Quick 700 W windlass

2.20 m. soft bottom dinghy

Mercury 3.5hp, 4 stroke outboard

Biminitop

Sprayhood

Cockpit cushions

Swimming platform with shower

Gangway

Life raft (6 person)

6 x Automatic inflatable life jackets

1 x Child life jacket

Barometer, Thermometer

Pilot books

Electronic and paper charts

220 V recharging system

Hot water

#### **Technische Daten:**

Länge über alles 10.28 m  
Breite 3.49 m  
Tiefgang 1.90 m  
Verdrängung 5.45 tonnen  
Wassertank 380 L  
Dieseltank 160 L  
Segelfläche 56 m<sup>2</sup>  
Latten-Grosssegel m. Lazy Bag  
Genua-Rollreffanlage  
Gennaker verfügbar (Optionale Extra)  
Motor Volvo 29 PS  
Kabinen 2 + Saloon  
Kojen 4 + 2  
WC und Dusche 1

2 Steuerrad

Faltbare Propeller

Teak cockpit

Warmluftheizung, diesel

300 W Wechselrichter

elektr. Kuehlaggregat

Radio, CD, USB, AUX-Eingang

Garmin GpsMap 5008 Kartenplotter, im Cockpit

1 x Garmin GMI 10 Anzeige

1 x Garmin GMI 20 Anzeige

(Geschwindigkeit, Tiefe, Wind)

Garmin GHC10 Autopilot Interface

Garmin VHF 200i VHF Radio

Ultra-Anker, 16 kg

Ultra-Schwenker, Kettenhaken

60 m x 10 mm Kette

Quick 700 W Ankerwinde

2.20 m. weichen Boden Beiboot

Mercury 3.5PS, 4-Takt-Außenbord

Biminitop

Sprayhood

Cockpitkissen

Badeplattform mit Dusche

Gangway

Rettingsinsel (6 Person)

6 x Auto. aufblasbare Schwimmweste

1 x Kinder-Schwimmweste

Barometer, Thermometer

Pilot Bücher

Elektronische und Papierkarten

Batterieladegerät

Warmwasser