

**JONES**  
Dufour Grand'Large 410  
2015

Tekne Adı / Boat Name / Name des Boots  
Model / Fabrikat  
Yıl / Year / Jahr

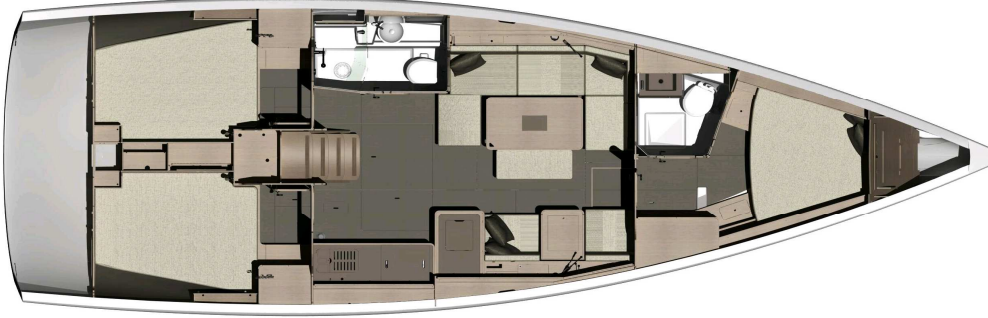

#### **Teknik Özellikler:**

Tam Boy	12.35 m
En	4.20 m
Su Çekimi	2.10 m
Ağırlık (boş)	8.94 ton
Su	380 lt
Mazot	200 lt
Yelken Alanı	71 m <sup>2</sup>
Sarma Ana Yelken	
Sarma Cenova	
Asimetrik balon yelken kullanılabilir (ekstra)	
Motor	Volvo 55 hp
Kamara	3 + Salon
Yatak	6 + 2
WC / Banyo	2

#### **Technical Data:**

Overall Length	12.35 m
Beam	4.20 m
Draft	2.10 m
Displacement	8.94 tons
Water	380 lt
Fuel	200 lt
Sail Area	71 m <sup>2</sup>
Furling mainsail	
Furling genoa	
Gennaker available (optional extra)	
Engine	Volvo 55 hp
Cabins	3 + Saloon
Berths	6 + 2
Heads / Showers	2

#### **Technische Daten:**

Länge über alles	12.35 m
Breite	4.20 m
Tiefgang	2.10 m
Verdrängung	8.94 tonnen
Wassertank	380 L
Dieseltank	200 L
Segelfläche	71 m <sup>2</sup>
Grosssegel-Rollreffanlage	
Genua-Rollreffanlage	
Gennaker verfügbar (Optionale Extra)	
Motor	Volvo 55 PS
Kabinen	3 + Saloon
Kojen	6 + 2
WC und Dusche	2

#### **2 Dümen simidi**

Katlanır pervane  
Yatağa dönüşebilir havuzluk oturakları  
Tik havuzluk  
1 x Elektrikli marin tuvalet (Ön)  
Kalorifer, mazotlu  
300 W Inverter (12V DC - 220V AC)  
Elektrikli buzdolabı  
Radyo, CD, USB, AUX girişi  
Raymarine es97 haritalı GPS, dümende  
2 x Raymarine i70 gösterge  
(Hız, Derinlik, Rüzgar)  
Raymarine p70 otopilot arayüzü  
Raymarine Ray49E VHF Telsiz  
Ultra çapa, 21 kg  
Ultra firdöndü, bosa kancası  
80 m x 10 mm zincir  
Quick 1000 W ırgat  
2.50 m. yumuşak tabanlı şişme bot  
Mercury 3.5hp, 4 zamanlı motor

#### **2 Steering wheels**

Folding propeller  
Convertible cockpit settees  
Teak cockpit  
1 x Electrical marine toilet (Front)  
Warm air heating, diesel  
300 W Inverter (12V DC - 220V AC)  
Electric fridge  
Radio, CD, USB, AUX input  
Raymarine es97 chartplotter, at the cockpit  
2 x Raymarine i70 display  
(Speed, Depth, Wind)  
Raymarine p70 autopilot interface  
Raymarine Ray49E VHF Radio  
Ultra anchor, 21 kg  
Ultra flip swivel, chain grab  
80 m x 10 mm chain  
Quick 1000 W windlass  
2.50 m. soft bottom dinghy  
Mercury 3.5hp, 4 stroke outboard

#### **2 Steuerrad**

Faltbare Propeller  
In Liegeflächen verwandelbare Sitzgruppe im Heckbereich  
Teak cockpit  
1 x Elektrische Marine-WC (Vorschiff)  
Warmluftheizung, diesel  
300 W Wechselrichter  
elektr. Kuehlaggregat  
Radio, CD, USB, AUX-Eingang  
Raymarine es97 Kartenplotter, im Cockpit  
2 x Raymarine i70 Anzeige  
(Geschwindigkeit, Tiefe, Wind)  
Raymarine p70 Autopilot Interface  
Raymarine Ray49E VHF Radio  
Ultra-Anker, 21 kg  
Ultra-Schwenker, Kettenhaken  
80 m x 10 mm Kette  
Quick 1000 W Ankerwinde  
2.50 m. weichen Boden Beiboot  
Mercury 3.5PS, 4-Takt-Außenbord

#### **Bimini güneşlik**

Serpinti körüğü  
Havuzluk minderleri  
Yüzme platformu ve duş  
Pasarella  
Can Salı (8 kişilik)  
8 x Otomatik şişme can yeleği  
1 x Çocuk can yeleği  
Barometre, Termometre  
Kılavuz kitaplar  
Elektronik ve kağıt haritalar  
220 V şarj sistemi  
Sıcak su

#### **Biminitop**

Sprayhood  
Cockpit cushions  
Swimming platform with shower  
Gangway  
Life raft (8 person)  
8 x Automatic inflatable life jackets  
1 x Child life jacket  
Barometer, Thermometer  
Pilot books  
Electronic and paper charts  
220 V recharging system  
Hot water

#### **Biminitop**

Sprayhood  
Cockpitkissen  
Badeplattform mit Dusche  
Gangway  
Rettungsinsel (8 Person)  
8 x Auto. aufblasbare Schwimmweste  
1 x Kinder-Schwimmweste  
Barometer, Thermometer  
Pilot Bücher  
Elektronische und Papierkarten  
Batterieladegerät  
Warmwasser