

IBULUT
Bavaria Cruiser 45
2013

Tekne Adı / Boat Name / Name des Boots
Model / Fabrikat
Yıl / Year / Jahr

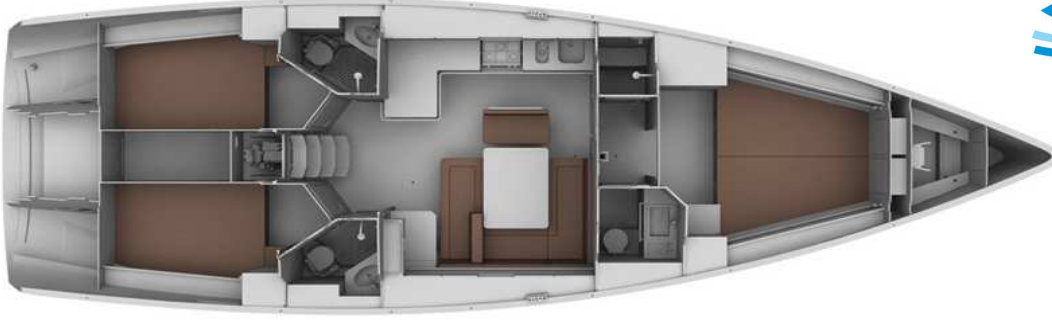

Teknik Özellikler:

Tam Boy	14.27 m
En	4.35 m
Su Çekimi	2.10 m
Ağırlık (boş)	12.6 ton
Su	360 lt
Mazot	210 lt
Yelken Alanı	107 m ²
Sarma Ana Yelken	
Sarma Cenova	
Asimetrik balon yelken kullanılabilir (ekstra)	
Motor	Volvo 75 hp
Kamara	3 + Salon
Yatak	6 + 1
WC / Banyo	3

Technical Data:

Overall Length	14.27 m
Beam	4.35 m
Draft	2.10 m
Displacement	12.6 tons
Water	360 lt
Fuel	210 lt
Sail Area	107 m ²
Furling mainsail	
Furling genoa	
Gennaker available (optional extra)	
Engine	Volvo 75 hp
Cabins	3 + Saloon
Berths	6 + 1
Heads / Showers	3

Technische Daten:

Länge über alles	14.27 m
Breite	4.35 m
Tiefgang	2.10 m
Verdrängung	12.6 tonnen
Wassertank	360 L
Dieseltank	210 L
Segelfläche	107 m ²
Grossegel-Rollrefanlage	
Genua-Rollrefanlage	
Gennaker verfügbar (Optionale Extra)	
Motor	Volvo 75 PS
Kabinen	3 + Saloon
Kojen	6 + 1
WC und Dusche	3

İpeksi mat gri gövde rengi
2 Dümen simidi
Baş manevra pervanesi
Tik havuzluk
1 x Elektrikli marin tuvalet (Ön)
Kalorifer, mazotlu
150 W Inverter (12V DC - 220V AC)
2 x Elektrikli buzdolabı
Radyo, CD, USB, AUX girişi
Garmin GpsMap4008 haritalı GPS, dümende
2 x Garmin GMI10 gösterge (Hız, Derinlik, Rüzgar)
Garmin GHC10 otopilot arayüzü
Garmin GHS10i VHF Telsiz
Ultra çapa, 27 kg
Ultra fırdöndü, bosa kancası
80 m x 10 mm zincir
Quick 1000 W ırgat
60 m. Ultraline makaralı yüzen yassı halat
2.50 m. yumuşak tabanlı şişme bot
Mercury 3.5hp, 4 zamanlı motor

Silk grey hull color
2 Steering wheels
Bow thruster
Teak cockpit
1 x Elektrikli marine toilet (Front)
Warm air heating, diesel
150 W Inverter (12V DC - 220V AC)
2 x Electric fridges
Radio, CD, USB, AUX input
Garmin GpsMap4008 chartplotter, at the cockpit
2 x Garmin GMI10 displays (Speed, Depth, Wind)
Garmin GHC10 autopilot interface
Garmin GHS10i VHF Radio
Ultra anchor, 27 kg
Ultra flip swivel, chain grab
80 m x 10 mm chain
Quick 1000 W windlass
60 m. Ultraline floating flat line and reel
2.50 m. soft bottom dinghy
Mercury 3.5hp, 4 stroke outboard

Graue (seidenmatt) Rumpffarbe
2 Steuerrad
Bugstrahlruder
Teak Cockpit
1 x Elektrische Marine-WC (Front)
Warmluftheizung, diesel
150 W Wechselrichter
2 x elektr. Kuehlaggregat
Radio, CD, USB, AUX-Eingang
Garmin GpsMap4008 Kartenplotter, im Cockpit
2 x Garmin GMI10 Anzeige (Geschwindigkeit, Tiefe, Wind)
Garmin GHC10 Autopilot Interface
Garmin GHS10i VHF Radio
Ultra-Anker, 27 kg
Ultra-Schwenker, Kettenhaken
80 m x 10 mm Kette
Quick 1000 W Ankerwinde
60 m. Ultraline flacher schwimmline und rolle
2.50 m. weichen Boden Beiboot
Mercury 3.5PS, 4-Takt-Außenbord

Bimini güneşlik
Serpinti körüğü
Havuzluk minderleri
Yüzme platformu ve duş
Pasarella
Can Salı (8 kişilik)
8 x Otomatik şişme can yeleği
1 x Çocuk can yeleği
Barometre, Termometre
Kılavuz kitaplar
Elektronik ve kağıt haritalar
220 V şarj sistemi
Sıcak su

Biminitop
Sprayhood
Cockpit cushions
Swimming platform with shower
Gangway
Life raft (8 person)
8 x Automatic inflatable life jackets
1 x Child life jacket
Barometer, Thermometer
Pilot books
Electronic and paper charts
220 V recharging system
Hot water

Biminitop
Sprayhood
Cockpitkissen
Badeplattform mit Dusche
Gangway
Rettungsinsel (8 Person)
8 x Auto. aufblasbare Schwimmweste
1 x Kinder-Schwimmweste
Barometer, Thermometer
Pilot Bücher
Elektronische und Papierkarten
Batterieladegeraet
Warmwasser