

HERAKLES
Dufour Grand'Large 350
2015

Tekne Adı / Boat Name / Name des Boots
Model / Fabrikat
Yıl / Year / Jahr

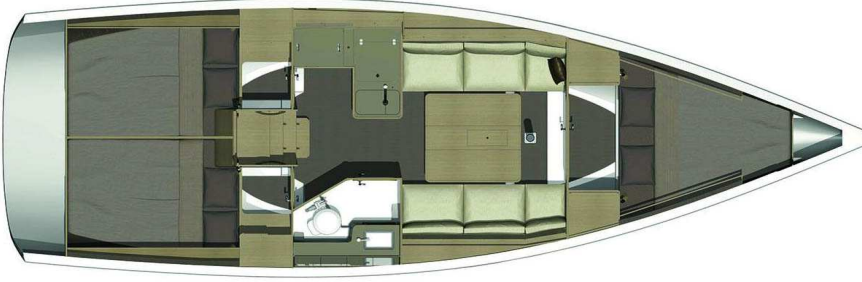

Teknik Özellikler:

Tam Boy	10.28 m
En	3.54 m
Su Çekimi	1.90 m
Ağırlık (boş)	5.67 ton
Su	380 lt
Mazot	160 lt
Yelken Alanı	55 m ²
Sarma Ana Yelken	
Sarma Flok (Kendinden Tramolalı)	
Asimetrik balon yelken kullanılabilir (ekstra)	
Motor	Volvo 29 hp
Kamara	3 + Salon
Yatak	6 + 2
WC / Banyo	1

2 Dümen simidi
Katlanır pervane
Tik havuzluk
Kalorifer, mazotlu
300 W Inverter (12V DC - 220V AC)
Elektrikli buzdolabı
Radyo, CD, USB, AUX girişi
Raymarine a75 haritalı GPS, dümende
1 x Raymarine i70 gösterge
(Hız, Derinlik, Rüzgar)
Raymarine p70 otopilot arayüzü
Raymarine Ray49E VHF Telsiz
Ultra çapa, 16 kg
Ultra fırdöndü, bosa kancası
60 m x 10 mm zincir
Lewmar 700 W ırgat
2.20 m. yumuşak tabanlı şişme bot
Mercury 3.5hp, 4 zamanlı motor

Bimini güneşlik
Serpinti körüğü
Havuzluk minderleri
Yüzme platformu ve duş
Pasarella
Can Salı (8 kişilik)
8 x Otomatik şişme can yeleği
1 x Çocuk can yeleği
Barometre, Termometre
Kılavuz kitaplar
Elektronik ve kağıt haritalar
220 V şarj sistemi
Sıcak su

Technical Data:

Overall Length	10.28 m
Beam	3.54 m
Draft	1.90 m
Displacement	5.67 tons
Water	380 lt
Fuel	160 lt
Sail Area	55 m ²
Furling mainsail	
Furling jib (Self Tacking)	
Gennaker available (optional extra)	
Engine	Volvo 29 hp
Cabins	3 + Saloon
Berths	6 + 2
Heads / Showers	1

2 Steering wheels
Folding propeller
Teak cockpit
Warm air heating, diesel
300 W Inverter (12V DC - 220V AC)
Electric fridge
Radio, CD, USB, AUX input
Raymarine a75 chartplotter, at the cockpit
1 x Raymarine i70 display
(Speed, Depth, Wind)
Raymarine p70 autopilot interface
Raymarine Ray49E VHF Radio
Ultra anchor, 16 kg
Ultra flip swivel, chain grab
60 m x 10 mm chain
Lewmar 700 W windlass
2.20 m. soft bottom dinghy
Mercury 3.5hp, 4 stroke outboard

Biminitop
Sprayhood
Cockpit cushions
Swimming platform with shower
Gangway
Life raft (8 person)
8 x Automatic inflatable life jackets
1 x Child life jacket
Barometer, Thermometer
Pilot books
Electronic and paper charts
220 V recharging system
Hot water

Technische Daten:

Länge über alles	10.28 m
Breite	3.54 m
Tiefgang	1.90 m
Verdrängung	5.67 tonnen
Wassertank	380 lt
Dieseltank	160 L
Segelfläche	55 m ²
Grosssegel-Rollreiffanlage	
Rollflock (selbstwendend)	
Gennaker verfügbar (Optionale Extra)	
Motor	Volvo 29 PS
Kabinen	3 + Saloon
Kojen	6 + 2
WC und Dusche	1

2 Steuerrad
Faltbare Propeller
Teak cockpit
Warmluftheizung, diesel
300 W Wechselrichter
elektr. Kuehlaggregat
Radio, CD, USB, AUX-Eingang
Raymarine a75 Kartenplotter, im Cockpit
1 x Raymarine i70 Anzeige
(Geschwindigkeit, Tiefe, Wind)
Raymarine p70 Autopilot Interface
Raymarine Ray49E VHF Radio
Ultra-Anker, 16 kg
Ultra-Schwenker, Kettenhaken
60 m x 10 mm Kette
Lewmar 700 W Ankerwinde
2.20 m. weichen Boden Beiboot
Mercury 3.5PS, 4-Takt-Außenbord