

FREZYA
Lagoon 400
2011

Tekne Adı / Boat Name / Name des Boots
Model / Fabrikat
Yıl / Year / Jahr

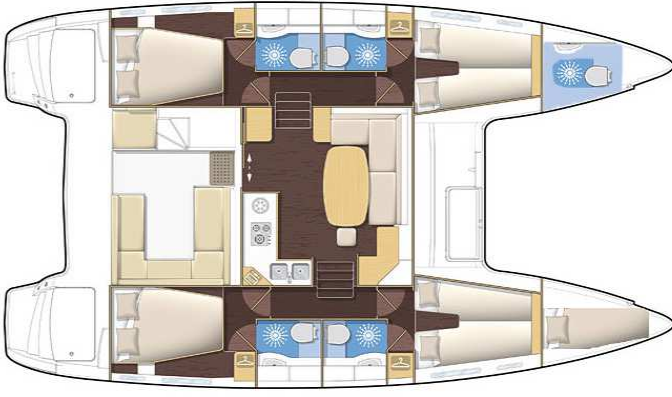

Teknik Özellikler:

Tam Boy	11.97 m
En	7.25 m
Su Çekimi	1.21 m
Ağırlık (boş)	10.35 ton
Su	630 lt
Mazot	400 lt
Yelken Alanı	88.5 m ²
Klasik Ana Yelken, tam balen	
Sarma Cenoa	
Asimetrik balon yelken kullanılabilir (ekstra)	
Motor	2 x Yanmar 40 hp
Kamara	4 + 1 + Saloon
Yatak	8 + 2 + 1
WC / Banyo	4 + 1

1 Dümen simidi

Tik havuzluk
4 x Elektrikli vinç
4 x Elektrikli marin tuvalet
150 W Inverter (12V DC - 220V AC)
2 x Elektrikli buzdolabı (önden açılan)
220 V mikrodalga fırın
Radyo, CD, USB, AUX girişi
Raymarine c120/w haritalı GPS, dümende
3 x Raymarine ST70 gösterge
(Hız, Derinlik, Rüzgar)
Raymarine ST70 otopilot arayüzü
Raymarine Ray49E VHF Telsiz
Radar
Ultra çapa, 21 kg
Ultra fırdöndü, bosa kancası
90 m x 10 mm zincir
Italwinch Thunder 1400 W ırgat
Zincir sayacı (dümende)
3.10 m. sert tabanlı şişme bot
Yamaha 10hp, 4 zamanlı motor

Havuzluk üzeri sabit güneşlik
Serpinti körüğü
Havuzluk minderleri
2 x Yüzme platformu ve duş
Pasarella
Can Salı (12 kişilik)
11 x Otomatik şişme can yeleği
1 x Çocuk can yeleği
Barometre, Termometre
Kılavuz kitaplar
Elektronik ve kağıt haritalar
220 V şarj sistemi
Sıcak su

Opsiyonel Ekstra

Jeneratör, 6.5 kW
Klima, tüm kamaralar ve salonda

*Sahil elektriğine bağlıyken ya da jeneratör çalışırken soğutma ve ısıtma

Technical Data:

Overall Length	11.97 m
Beam	7.25 m
Draft	1.21 m
Displacement	10.35 tons
Water	630 lt
Fuel	400 lt
Sail Area	88.5 m ²
Fully battened mainsail with lazy bag	
Furling genoa	
Gennaker available (optional extra)	
Engine	2 x Yanmar 40 hp
Cabins	4 + 1 + Saloon
Berths	8 + 2 + 1
Heads / Showers	4 + 1

1 Steering wheel

Teak cockpit
4 x Electric winches
4 x Electrical marine toilets
150 W Inverter (12V DC - 220V AC)
2 x Electric fridges (front opening)
220 V microwave oven
Radio, CD, USB, AUX input
Raymarine c120/w chartplotter, at the cockpit
3 x Raymarine ST70 displays
(Speed, Depth, Wind)
Raymarine ST70 autopilot interface
Raymarine Ray49E VHF Radio
Radar
Ultra anchor, 21 kg
Ultra flip swivel, chain grab
90 m x 10 mm chain
Italwinch Thunder 1400 W windlass
Chain counter (at the cockpit)
3.10 m. rigid bottom dinghy
Yamaha 10hp, 4 stroke outboard

Hardtop over the cockpit
Sprayhood
Cockpit cushions
2 x Swimming platforms with shower
Gangway
Life raft (12 person)
11 x Automatic inflatable life jackets
1 x Child life jacket
Barometer, Thermometer
Pilot books
Electronic and paper charts
220 V recharging system
Hot water

Available as an Optional Extra

Generator, 6.5 kW
Air conditioning in all cabins & saloon

*Cooling or heating when connected to shore power or while generator is running

Technische Daten:

Länge über alles	11.97 m
Breite	7.25 m
Tiefgang	1.21 m
Verdrängung	10.35 tonnen
Wassertank	630 L
Dieseltank	400 L
Segelfläche	88.5 m ²
Latten-Grosssegel m. Lazy Bag	
Genua-Rollreiffanlage	
Gennaker verfügbar (Optionale Extra)	
Motor	2 x Yanmar 40 PS
Kabinen	4 + 1 + Saloon
Kojen	8 + 2 + 1
WC und Dusche	4 + 1

1 Steuerrad

Teak cockpit
4 x elektrische Seilwischen
4 x Elektrische Marine-WC
150 W Wechselrichter
2 x elektr. Kuehlaggregate (Frontöffnung)
220 V Mikrowelle Backofen
Radio, CD, USB, AUX-Eingang
Raymarine c120/w Kartenplotter, im Cockpit
3 x Raymarine ST70 Anzeige
(Geschwindigkeit, Tiefe, Wind)
Raymarine ST70 Autopilot Interface
Raymarine Ray49E VHF Radio
Radar
Ultra-Anker, 21 kg
Ultra-Schwenker, Kettenhaken
90 m x 10 mm Kette
Italwinch Thunder 1400 W Ankerwinde
Kettenzähler (im cockpit)
3.10 m. starren Boden Beiboot
Yamaha 10PS, 4-Takt-Außenbord

Hardtop über dem Cockpit
Sprayhood
Cockpitkissen
2 x Badeplattform mit Dusche
Gangway
Rettungsinsel (12 Person)
11 x Auto. aufblasbare Schwimmweste
1 x Kinder-Schwimmweste
Barometer, Thermometer
Pilot Bücher
Elektronische und Papierkarten
Batterieladegeraet
Warmwasser

Extra-Optionen

Generator, 6.5 kW
Klimaanlage in allen Kabinen & Salon

*Kühlung bzw. Heizung beim elektrischen Landanschluss oder im Generatorbetrieb