

CINDERELLA
Dufour Grand'Large 410
2013

Tekne Adı / Boat Name / Name des Boots
Model / Fabrikat
Yıl / Year / Jahr

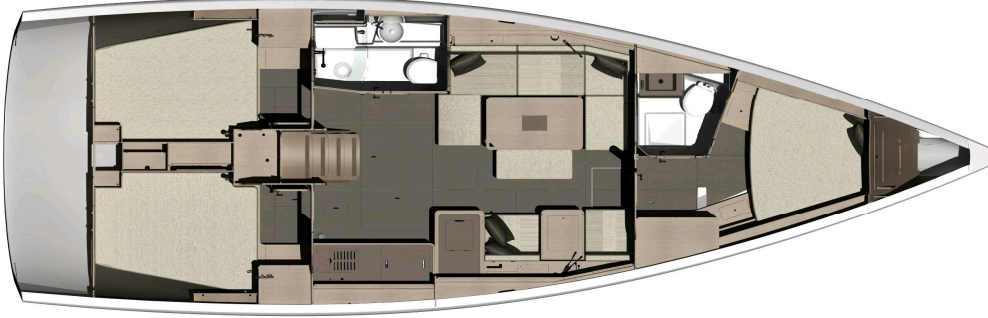

Teknik Özellikler:

Tam Boy	12.35 m
En	4.20 m
Su Çekimi	2.10 m
Ağırlık (boş)	8.94 ton
Su	380 lt
Mazot	200 lt
Yelken Alanı	71 m ²
Sarma Ana Yelken	
Sarma Cenova	
Asimetrik balon yelken kullanılabilir (ekstra)	
Motor	Volvo 55 hp
Kamara	3 + Salon
Yatak	6 + 2
WC / Banyo	2

Technical Data:

Overall Length	12.35 m
Beam	4.20 m
Draft	2.10 m
Displacement	8.94 tons
Water	380 lt
Fuel	200 lt
Sail Area	71 m ²
Furling mainsail	
Furling genoa	
Gennaker available (optional extra)	
Engine	Volvo 55 hp
Cabins	3 + Saloon
Berths	6 + 2
Heads / Showers	2

Technische Daten:

Länge über alles	12.35 m
Breite	4.20 m
Tiefgang	2.10 m
Verdrängung	8.94 tonnen
Wassertank	380 L
Dieseltank	200 L
Segelfläche	71 m ²
Grosssegel-Rollreiffanlage	
Genua-Rollreiffanlage	
Gennaker verfügbar (Optionale Extra)	
Motor	Volvo 55 PS
Kabinen	3 + Saloon
Kojen	6 + 2
WC und Dusche	2

2 Dümen simidi

Yatağa dönüşebilir havuzluk oturakları

Tik havuzluk

1 x Elektrikli marin tuvalet (Ön)

300 W Inverter (12V DC - 220V AC)

Elektrikli buzdolabı

Radio, CD, USB, AUX girişi

Raymarine e95 haritalı GPS, dümende

2 x Raymarine i70 gösterge

(Hız, Derinlik, Rüzgar)

Raymarine p70 otopilot arayüzü

Raymarine Ray49E VHF Telsiz

Ultra çapa, 21 kg

Ultra fırdöndü, bosa kancası

70 m x 10 mm zincir

Quick 1000 W ırgat

Zincir sayacı (dümende)

60 m. Ultraline makaralı yüzen yassı halat

2.30 m. yumuşak tabanlı şişme bot

Yamaha 2.5hp, 4 zamanlı motor

2 Steering wheels

Convertible cockpit settees

Teak cockpit

1 x Electrical marine toilet (Front)

300 W Inverter (12V DC - 220V AC)

Electric fridge

Radio, CD, USB, AUX input

Raymarine e95 chartplotter, at the cockpit

2 x Raymarine i70 display

(Speed, Depth, Wind)

Raymarine p70 autopilot interface

Raymarine Ray49E VHF Radio

Ultra anchor, 21 kg

Ultra flip swivel, chain grab

70 m x 10 mm chain

Quick 1000 W windlass

Chain counter (at the cockpit)

60 m. Ultraline floating flat line and reel

2.30 m. soft bottom dinghy

Yamaha 2.5hp, 4 stroke outboard

2 Steuerrad

In Liegeflächen verwandelbare Sitzgruppe im HeckBereich

Teak cockpit

1 x Elektrische Marine-WC (Vorschiff)

300 W Wechselrichter

elektr. Kuehlaggregat

Radio, CD, USB, AUX-Eingang

Raymarine e95 Kartenplotter, im Cockpit

2 x Raymarine i70 Anzeige

(Geschwindigkeit, Tiefe, Wind)

Raymarine p70 Autopilot Interface

Raymarine Ray49E VHF Radio

Ultra-Anker, 21 kg

Ultra-Schwenker, Kettenhaken

70 m x 10 mm Kette

Quick 1000 W Ankerwinde

Kettenzähler (im cockpit)

60 m. Ultraline flacher schwimtleine und rolle

2.30 m. weichen Boden Beiboot

Yamaha 2.5PS, 4-Takt-Außenbord

Bimini güneşlik

Serpinti körüğü

Havuzluk minderleri

Yüzme platformu ve duş

Pasarella

Can Salı (8 kişilik)

8 x Otomatik şişme can yeleği

1 x Çocuk can yeleği

Barometre, Termometre

Kılavuz kitaplar

Elektronik ve kağıt haritalar

220 V şarj sistemi

Sıcak su

Biminitop

Sprayhood

Cockpit cushions

Swimming platform with shower

Gangway

Life raft (8 person)

8 x Automatic inflatable life jackets

1 x Child life jacket

Barometer, Thermometer

Pilot books

Electronic and paper charts

220 V recharging system

Hot water

Biminitop

Sprayhood

Cockpitkissen

Badeplattform mit Dusche

Gangway

Rettingsinsel (8 Person)

8 x Auto. aufblasbare Schwimmweste

1 x Kinder-Schwimmweste

Barometer, Thermometer

Pilot Bücher

Elektronische und Papierkarten

Batterieladegeraet

Warmwasser